



OMNI-408A

User Guide

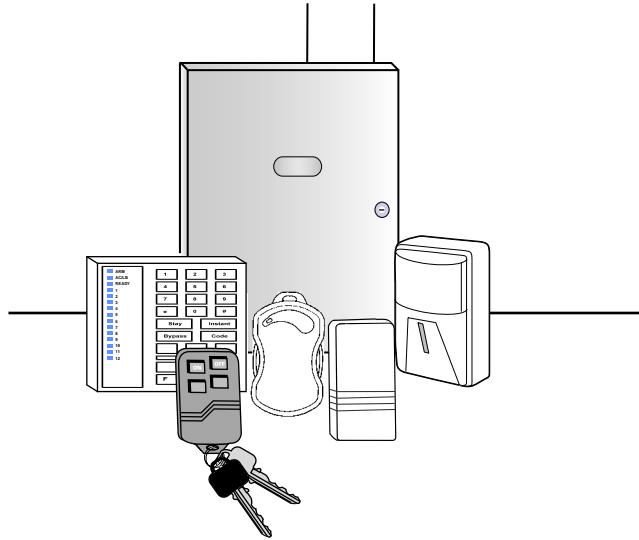

Table of Contents

QUICK REFERENCE.....	3	Add or Change a User Code	17
System Turn On	3	Delete a User Code	17
System Turn Off	3	PAGER.....	18
System Turn On/Stay Inside.....	3	Follow-Me Displays	18
System Turn On/Stay Inside/Instant Mode.	3	Changing the Pager Follow-Me Phone	
Smoke Detector Reset	3	Number.....	18
INTRODUCTION.....	4	KEYPAD FUNCTIONS.....	20
SYSTEM REFERENCE	5	System Turn On (Maid Code).....	20
ABOUT THE XL-108 KEYPAD.....	7	Send Help Conditions.....	20
SYSTEM OPERATION	11	TESTING THE SYSTEM.....	23
System Turn On/Leave.....	11	System Test.....	23
System Turn On/Stay Inside.....	12	Battery Test	23
System Turn On/Stay Inside/Instant Mode		INSTALLATION LAYOUT	25
.....	12	SYSTEM LIMITATIONS.....	27
Bypass.....	13	GLOSSARY	30
Unbypass.....	14	TELEPHONE OPERATIONAL PROBLEMS	35
System Turn Off	14		
USER CODES.....	17		

Quick Reference

Quick Reference

System Turn On

Check to make sure the system is READY - Green READY LED is lit.
Enter your 4-digit user code (or press the Arm button on your keyfob).
The ARM LED goes on.
Exit through a door designated by your installer as an exit/entry door.

System Turn Off

Enter through door designated by your installer as an exit/entry door.
Enter your 4-digit user code (or press the Disarm button on your keyfob).
The ARM LED goes out.

System Turn On/Stay Inside

Check to make sure the system is READY - Green READY LED is lit.
Press followed by your user code.
The ARM and STAY LEDs light.

You must turn the system off if you want to open the door or leave the premises after the exit time has passed.

System Turn On/Stay Inside/Instant Mode

Check to make sure the system is READY - Green READY LED is lit.
Press then followed by your user code.
The ARM LED, the INST (instant) LED, and the STAY LED are all lit.

Smoke Detector Reset

Enter your 4-digit user code.

Introduction

Introduction

Congratulations on your decision to protect your home or business with the OMNI-408A security system. You have chosen a reliable, state-of-the-art security system that is remarkably easy to operate. Representatives from your local security company, who can explain the specifics of your system, have professionally installed your system.

The keypad is the input and display device for your security system. Your system uses an XK-108 keypad. The XK-108 is a surface-mount keypad containing indicator lights for each of the 8 zones (areas of protection). The door covering the keys is optional and can be removed.

The OMNI-408A is listed by Underwriters Laboratories for Household Fire and Burglary applications.

Throughout this guide, the following conventions are used to display the keystrokes required to perform the functions.

Bypass	Key labeled [Bypass]
Instant	Key labeled [Instant]
Stay	Key labeled [Stay]
Code	Key labeled [Code]

Please keep your guide in a convenient location so you can refer to it if needed.

System Reference

System Reference

ZONE	DESCRIPTION
1	_____
2	_____
3	_____
4	_____
5	_____
6	_____
7	_____
8	_____

ENTRY TIME	DOOR	EXIT TIME
_____	_____	_____
ENTRY TIME	DOOR	_____

Entry Time is the same for all designated entry/exit doors.

The following SEND HELP ALERTS are programmed into your system. Both keys must be pressed at the same time to activate the alert. The keys you press depend on which type of keypad you have. Your installer will show you how to activate these emergency keys.

EMERGENCY KEYS	DESCRIPTION	KEYS
Left Pair	_____	[#] & [*]
Center Pair	_____	[7] & [9]
Right Pair	_____	[1] & [3]

See page 7 of this User Guide for a picture of the XK-108 keypad for emergency key references.

System Reference (cont'd)

USER ID	ASSIGNED TO
1	_____ (MASTER USER 1)
2	_____
3	_____
4	_____
5	_____
6	_____

*Master User can add, change, or erase other user codes.

MONITORING STATION INFORMATION

Account # _____

Telephone # _____

XL-108 Keypad

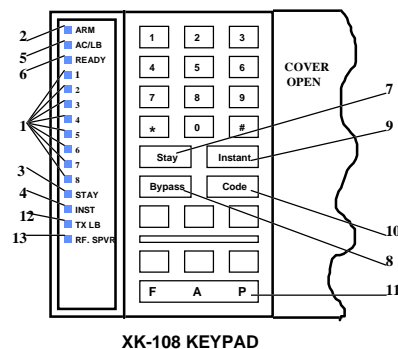

About the XL-108 Keypad

1) Zone Status LEDs

These LEDs display the current zone status, including alarms, bypasses, troubles, and faults. Each condition causes these LEDs to operate differently, as follows:

ALARMS – Fast blink (approx. 150mS on - 150mS off).

TROUBLES – Slow pulse (approx. 600mS on - 600mS off).

BYPASSES – Wink (100mS on - 900mS off). Zone bypasses are displayed as a very slow wink of the zone LED.

FAULTED ZONES – Solid on. Faulted zones are the lowest-priority indication. Faulted burglary zones are displayed with the LED solidly on while the system is disarmed.

NORMAL – Off

2) ARM LED

This LED indicates whether the system is currently armed (on) or disarmed (off). This LED also blinks fast to show that alarms have occurred, or blinks slowly upon failure to communicate with the central station.

XL-108 Keypad (cont'd)

3) STAY LED

This LED indicates whether the system has been armed in the STAY mode or the STAY/INSTANT mode. If the INST LED is lit and the STAY LED is lit, then the system is in the STAY/INSTANT mode. If the INST LED is off and the STAY LED is lit, then the system is in the STAY mode only. In either mode, the STAY LED indicates the following:

Lit	Interior zones are bypassed
Off	Interior zones are active armed

4) INST (Instant) LED

This LED indicates whether the system has been armed in the STAY/INSTANT mode. In this mode the system is currently armed, all delay zones are instant, and all interior zones are bypassed.

Lit	Delay zones are currently instant
Off	Delay zones are normal

5) AC/LB (Low Battery) LED

This LED indicates the current power status of the panel as follows:

Lit	AC is present
Off	No AC, running on battery backup
Slow Blink	Low-battery condition detected

XL-108 Keypad (cont'd)

6) READY LED

This LED indicates whether the system is ready for arming. The READY LED is common to all BURGLARY ZONES, and defines the following conditions:

Lit	System ready to be armed
Off	System not ready to be armed
Slow Blink	Installer programming mode
Fast Blink	Alarm memory mode

7) Stay Key

The [Stay] key enables arming the system, excluding zones programmed as interior zones. This provides exterior protection of the location while allowing full access throughout the interior.

8) Bypass Key

The [Bypass] key is used to temporarily exclude protection of a specific zone.

9) Instant Key

The [Instant] key enables arming the system, eliminating entry/exit delays. If enabled with the [Stay] key, it enables arming the system in the STAY/INSTANT mode.

10) Code Key

The [Code] key is used to enter the installer programming mode and enter user codes.

XL-108 Keypad (cont'd)

11) Keypad Auxiliary Keys

Pressing the two keys (top and bottom) labeled "P" at the same time initiates a CS transmission, if programmed, of PANIC, AUXILIARY, or FIRE, annunciates the keypad sounder, and turns on the bell output. If not programmed to transmit, these keys can only result in a local warning, as follows:

Keypad Sounder - Steady for PANIC, Pulsing for FIRE and AUXILIARY

Bell Output - Steady for PANIC, Pulsing for FIRE

12) TX LB LED

This LED pulses whenever any RF transmitter has a low battery. The corresponding zone LED for that transmitter also pulses.

13) RF SPVR LED

This LED indicates three different RF supervisory conditions and one bell output supervisory condition, as follows:

Off	No supervision conditions exist (normal)
Lit	RF transmitter has not checked in for more than 12 hours
Fast Blink	RF transmitter reports a tamper condition
Slow Blink	Bell output is in supervision

System Operation

System Operation

You can turn the Burglar portion of your security system on and off. Before you turn the system on, it must be ready. If you have a protected door open, or someone is moving near a motion detector, the system is not ready and the READY LED is not lit.

The system is ready if the READY LED is lit.

System Turn On/Leave

Enter your 4-digit user code.

The ARM LED lights.

Exit through a door designated by your installer as an exit/entry door. You must leave within the period of time known as the exit time. Check the reference sheet for the time that has been set for your system.

If the system is not ready to be armed, the READY LED is off. The zone lights can have the following conditions:

Fast Blink	Alarm
Slow Blink/Low Intensity	Bypass (Note that you will get a lit READY LED if all faulted zones are bypassed.)
Slow Pulse	Trouble
Solid On	Not Ready

Example: If the READY LED is not lit and the zone no.1 light is solid on, an alarm sensor on zone no. 1 is not normal. This might mean that a window is open or someone is walking near a motion sensor. Check all sensors on zone no. 1 and resolve the problem. When all sensors are normal, the READY LED goes on and the zone no. 1 light goes out.

System Operation (cont'd)

Determine which zone or zones are not ready, resolve the problem, and turn the system on normally. If the problem cannot be resolved, you may bypass the zone that is not ready. Bypassing should be done only if the problem on the zone cannot be resolved OR if you intentionally wish to leave the zone off. Example: You wish to keep the window open for ventilation. Bypassed zones are not protected when the system is on. See Bypass for the correct procedure.

System Turn On/Stay Inside

The STAY mode turns the perimeter portion of your burglar alarm on and allows you to move around freely inside the premises.

Check to make sure the system is READY; when ready, press:

followed by your user code.

The ARM LED and the STAY LED should now be lit.

You must turn the system off if you want to open the door or leave the premises after the exit time has passed.

System Turn On/Stay Inside/Instant Mode

In INSTANT STAY mode, the perimeter portion of your burglar alarm system is on and the time delays are eliminated from your normal entry/exit door(s). All interior protection is off (if so programmed), so you are free to move around inside.

Check to make sure the system is READY; when ready:

Press then followed by your user code.

The ARM LED, INST LED, and STAY LED should now be lit.

System Operation (cont'd)

In INSTANT mode, all alarm sensors, including sensors on doors that normally have a delay to allow you to turn the system off, report an alarm immediately, if activated.

Check to make sure the system is READY; when ready, press:

Instant followed by your user code.

The ARM LED and the INST LED should now be lit.

Bypass

Bypass excludes a zone of protection from the security system until it is unbypassed or until the next time you disarm the system. Bypassing can only be done while the system is turned off.

Press the [Bypass] key followed by your user code and then the zone no. (1-8) to be bypassed.

Bypass , 4-digit user code*, zone no.

*If Quick Bypass is enabled, you need only to press the [Bypass] key and the zone no.

-
- Bypassed zones are not protected when the system is turned on. After the bypass command has been accepted, the keypad sounds one long beep and the zone or zones bypassed slowly blink.
 - Temporary users (i.e., baby sitters, housekeepers, etc.) should not be shown the Bypass procedure.
-

System Operation (cont'd)

Unbypass

Unbypass returns a bypassed zone to normal operation.

Unbypass is a repeat of the Bypass function. Press the [Bypass] key followed by your user code and then the zone no. (1-8) to be unbypassed.

Bypass , 4-digit user code, zone no.

-
- If Quick Bypass is enabled, you need only to press the [Bypass] key and the zone no.
 - Fire zones cannot be bypassed.
 - 24-Hour zones can be bypassed: however, they cannot be unbypassed if they are violated.
 - Subsequent bypasses and unbypasses without Quick Bypass enabled can be made by pressing the [Bypass] key, and then pressing another zone no. within a 10-second period. After the 10-second period has expired, the entire command including user code must be entered.
-

After unbypassing, the zone displays indicate the state of the zones.

System Turn Off

When you turn off the system, you turn off only the burglar portion of your system; any smoke or heat detectors and panic keys remain on. You must enter through a designated entry door and turn off the system within the time allowed. You can have different amounts of time for different entry points. See your system reference sheet for the times established for your system.

Enter your 4-digit user code.

If no alarms have taken place, the ARM LED goes out.

System Operation (cont'd)

If alarms occurred when the system was on, or if a trouble condition exists, the event or condition is displayed on the zone LEDs as follows:

Fast Blink	Alarm
Slow Blink/Low Intensity	Bypass
Slow Pulse	Trouble
Solid On	Not Ready

Burglary Alarms generate a steady sound through the keypad(s).

Fire alarms generate a pulsing sound.

Important: If an intrusion has taken place while you were away, do not enter until the location has been checked. Call for help from a neighbor's house and wait for the police.

After you have turned the system off with your user code, the keypad will indicate Alarm Memory.

To clear the display of the alarm or trouble conditions and silence the audible alert:

Enter your 4-digit user code again.

System Operation (cont'd)

User Codes

User Codes

Add or Change a User Code

Users can be entered or modified directly through the keypad. Your system can have up to 6 different user codes. User no.1 is the Master User and is the only one allowed to add or delete other users.

Press the [Code] key followed by the 4-digit Master User code, then the user no. and the new 4-digit user code. The keypad beeps after each digit is pressed.

Code , 4-digit Master User Code, user ID (1-6), new user code.

Record sheets are provided in this guide to help you plan and record your users. On this sheet, your installer will indicate if you have chosen to dedicate a user code to send an emergency signal in the case of ambush or duress. You may also have chosen to reserve one user code that is allowed only to turn the system on; this code will not be able to turn the system off.

Delete a User Code

To delete user no. 3, press the [Code] key followed by the 4-digit Master User Code, then the user no., then [*] to delete.

Code , 4-digit Master User Code, user ID (3), [*].

User No. 1, the Master User, cannot be deleted, but it can be changed using the ADD OR CHANGE USER PROCEDURE.

Pager

Pager

Follow-Me Displays

The display shown on your pager is "ACCTEXXX" where:

"ACCT" is the 4-digit central station no. 2 account number.

"E" is the event code. There are 4 event types: alarms, troubles, openings, and closings. These event codes are as follows:

Openings = 0, Closings = 1, Alarm or Trouble = 9

If multiple events occur, the signal for the highest-priority event is sent first. Events ranked from highest to lowest priority are alarms, trouble, open, and close.

"XXX" is, depending on the event, the zone (01-08) or user (1-14) designation.

USER DESIGNATION	FUNCTION
1-6	User codes
7	Remote arm/disarm
8	Quick Arm #1, Quick Forced Arm #2
9-14	Keyfobs

Changing the Pager Follow-Me Phone Number

You can change your pager follow-me phone number as follows if your installer enabled this feature:

Pager (cont'd)

1. Access pager number programming by pressing in sequence the [#], [5], and [8] keys. An acknowledgement tone sounds to indicate pager number programming has been accessed.
-

The [#], [5], [8] command is accessible only while the system is disarmed and the dialer, dialer delay, and bell are not active.

In pager phone number programming mode, there is no visual keypad display of the numbers already programmed or numbers that are being changed.

2. Enter your new pager phone number. Your new pager phone number may consist of up to 16 characters (1-9, 0). It may be necessary to add time to allow the pager to answer before dialing your pager number. To enter a 2-second pause, press the [Code] key. (Entering a 2-second pause is optional and is not required to enter your pager phone number.) If the [Code] key was pressed, it counts as one character. The keypad will emit a single acknowledgement chirp as each number is pressed.
3. Press the [#] key after you have made your pager phone number changes. Pressing the [#] key saves your new pager number and nulls out the remaining locations. An acknowledgement tone sounds.

To exit without saving changes, press the [*] key to exit pager phone number programming. An acknowledgement tone sounds to indicate pager number programming has been exited.

If you press the [*] key without first pressing the [#] key to save your new pager phone number, the system exits the pager phone number programming mode without saving the changes.

If no key is pressed within 10 seconds, the pager phone number programming mode times out and exits automatically without saving any information entered.

Keypad Functions

Keypad Functions

System Turn On (Maid Code)

If you choose to have a code that cannot turn the system off, but can turn the system on, have your installer program this feature. If programmed, user code no. 5 has system on capability only, and you can issue this code to a temporary user so they can secure the premises when they leave.

Send Help Conditions

Your system can be programmed for three separate Send Help Alerts, which send an emergency signal to your central station. These three alerts, along with their keypad combinations, are shown below:

Fire	Panic	Aux
[7] & [9]	[*] & [#]	[1] & [3]

Duress

Your system can be programmed to send an emergency signal to the central station if you are forced to enter the premises. If you choose to include this feature, user code no. 6 is dedicated to this function and must only be used under a duress circumstance.

Quick On (Quick Arming) Yes **No**

If programmed by your installer, Quick On, or Quick Arming, allows you to turn the system on to the Away mode without entering a user code. To enable Quick On:

Press [#], [1].

Keypad Functions (cont'd)

Quick Forced On Yes No

If programmed by your installer, Quick Forced On allows you to turn the burglar portion of your alarm system on to the Away Mode bypassing all zones that are not ready. To enable Quick Force On:

Press [#], [2].

A valid user code is still required to turn the system off.

UL

The Quick Forced On feature is disabled on UL installations.

Quick Exit Yes No

If enabled, this feature allows the user to exit without having to disarm then arm the system. It is activated by pressing the [Stay] key while the system is armed and not in entry delay. This starts exit time, causes the keypad to beep once, and allows the user to exit without disarming the system. The system returns to its last armed state after exit time has expired.

Quick Bypass Yes No

If you have Quick Bypass programmed for your system, you do not have to use your user code to bypass zones. The Quick Bypass procedure is:

Bypass , Zone No. (1-8)

Bypassed zones are not protected when the system is turned on. After the Bypass command has been accepted, the keypad sounds one long beep and the zone or zones bypassed slowly blink.

Keypad Functions (cont'd)

Set Time and Date

To set the time and date press [#], [3]. Enter 2 digits each for hours, minutes, month, day, and year.

hours (00-23) minutes (01-59)

month (01-12) day (01-31) year (00-99)

In order to acknowledge your entry, a beep sounds after you set each component of the time and date.

Turn Chime On/Off

Chime is an optional feature that causes the keypad to chime when selected doors are opened when the burglary protection is off or disarmed.

Only your installer can program a zone for the Chime feature, but once it is programmed, you can turn Chime on or off to meet your daily needs. To turn Chime on or off:

Press [#], [6]

Testing the System

Testing the System

System Test

We recommend that you test your system once a week using the following procedure:

If your system is monitored, contact your central station before you perform this test.

1. Turn your security system on.
2. Wait until your exit time is over and then activate the system by opening a protected zone (for example, a window or door).
3. Confirm that the alarm sounding device (bell or siren) sounds. If your system is connected to a central station, the keypad will sound the ringback tone to confirm that the signal was received.
4. Turn the security system off.
5. Call the central station to tell them you are finished testing.

Battery Test

We recommend that you test your battery once a month. To test your backup/standby battery, follow this procedure.

1. Unplug the transformer from the AC outlet by removing the restraining screw that secures the transformer to the wall.
-

The restraining screw is not present on models sold in Canada.

2. Observe that the AC indicator light on the keypad goes off.
 3. Activate your alarm by performing the above SYSTEM TEST. Remember to contact your central station if your system is monitored.
-
-

Test the System (cont'd)

4. Plug the transformer into the AC outlet and secure with the restraining screw.

The National Fire Protective Association publishes a standard for fire warning equipment (NFPA publication no. 74). Further information can be obtained by contacting NFPA Public Affairs Dept., Batterymarch Park, Quincy, MA 02269.

If you have any further questions about the operation of your system, please contact your alarm company.

Installation Layout

Early-warning fire detection is best achieved by the installation of smoke detectors in the locations marked by a "+" in the diagram below.

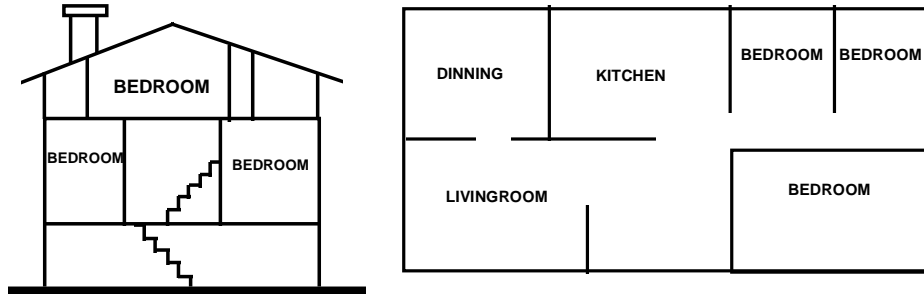

Typical Smoke Detector Layout

Installation Layout

In homes with more than one sleeping area, a smoke detector should be provided to protect each area. Smoke detectors shall be located between the sleeping area and the rest of the house

Preparation of an evacuation plan is of prime importance in fire prevention. Establish a household or business emergency evacuation plan to be followed in the event of a fire, using these guidelines:

1. Evaluate possible escape routes from your home or business.
2. Select two escape routes from each room.
3. Rooms on the second floor should have a rope ladder (make sure it reaches the ground) or fire escape.
4. Draw a rough sketch of your escape plan so everyone is familiar with it.
5. Practice your escape plan to make sure everyone knows what to do.

Installation Layout (cont'd)

6. Establish a meeting place outside where everyone will meet after evacuation.
7. Advise the local fire authority that you have installed a fire alarm system.
8. When the fire alarm signals, LEAVE IMMEDIATELY. Do not stop for belongings.
9. If a fire occurs, test the door. If the door is hot, use your alternate route to evacuate. If the door is cool, brace your shoulder against it and open it cautiously. Shut the door behind you to help prevent the fire and smoke from spreading. Crawl through smoke holding your breath.
10. Contact the fire department from a neighboring house or business.
11. Everyone, including neighbors, should be familiar with your fire and burglary audible alarm sounders.

Fire Alarm Sound is: _____

Burglar Alarm Sound is: _____

System Limitations

System Limitations

While this system is an advanced-design security system, it does not offer guaranteed protection against burglary, fire, or other emergency. Any alarm system, whether commercial or residential, is subject to compromise or failure to warn for a variety of reasons. For example:

- Intruders may gain access through unprotected openings or have the technical sophistication to bypass an alarm sensor or disconnect an alarm warning device.
- Intrusion detectors (e.g., passive infrared detectors), smoke detectors, and many other sensing devices will not work without batteries or if the batteries are not put in properly. Devices powered solely by AC will not work if their AC power supply is cut off for any reason, however briefly.
- Signals sent by wireless transmitters may be blocked or reflected by metal before they reach the alarm receiver. Even if the signal path has been recently checked during a weekly test, blockage can occur if a metal object is moved into the path.
- A user may not be able to reach a panic or emergency button quickly enough.
- While smoke detectors have played a key role in reducing residential fire deaths in the United States, they may not activate or provide early warning for a variety of reasons in as many as 35 percent of all fires, according to data published by the Federal Emergency Management Agency. Some of the reasons smoke detectors used in conjunction with the system may not work are as follows: Smoke detectors may not sense fires that start where smoke cannot reach the detectors, such as in chimneys, in walls, on roofs, or on the other side of closed doors. Smoke detectors also may not sense a fire on another level of a residence or building. A second-floor detector, for example, may not sense a first-floor or basement fire. Moreover, smoke detectors have sensing limitations. No smoke detector can sense every kind of fire every

System Limitations (cont'd)

time. In general, detectors may not always warn about fires caused by carelessness and safety hazards like smoking in bed, violent explosions, escaping gas, improper storage of flammable materials, overloaded electrical circuits, children playing with matches, or arson. Depending on the nature of the fire and/or the location of the smoke detectors, the detector, even if it operates as anticipated, may not provide sufficient warning to allow all occupants to escape in time to prevent injury or death.

- A passive infrared motion detector can detect intrusion only within the designed ranges as diagrammed in its installation manual. Passive infrared detectors do not provide volumetric area protection. They do create multiple beams of protection, and intrusion can be detected only in unobstructed areas covered by the beams. They cannot detect motion or intrusion that takes place behind walls, ceilings, floors, closed doors, glass partitions, glass doors, or windows. Mechanical tampering, masking, painting, or spraying, of any material on the mirrors, windows, or any part of the optical system can reduce their detection ability. Passive infrared detectors sense changes in temperature; however, as the ambient temperature of the protected area approaches the temperature range of 90 degrees to 150 degrees Fahrenheit, the detection performance can decrease.
- Alarm warning devices such as sirens, bells, or horns may not alert people or wake up sleepers who are located on the other side of closed or partly open doors. If warning devices sound on a different level of the residence from the bedrooms, then they are less likely to waken or alert people inside the bedrooms. Even persons who are awake may not hear the warning if the alarm is muffled by noise from a stereo, radio, air conditioner, other appliances, or by passing traffic. Finally, alarm warning devices, however loud, may not warn hearing-impaired people or waken deep sleepers.

System Limitations (cont'd)

- Telephone lines needed to transmit alarm signals from a premises to a central monitoring station may be out of service. Telephone lines are also subject to compromise by sophisticated intruders.
- However, even if the system responds to the emergency as intended, occupants may have insufficient time to protect themselves from the emergency situation. In the case of a monitored alarm system, authorities may not respond appropriately.
- This equipment, like other electrical devices, is subject to component failure. Even though this equipment is designed to last as long as 10 years, the electronic components could fail at any time.

The most common cause of an alarm system not functioning when an intrusion or fire occurs is inadequate maintenance. This alarm system should be tested weekly to make sure all sensors are working properly.

Installing an alarm system may make one eligible for lower insurance rates, but an alarm system is not a substitute for insurance. Homeowners, property owners, and renters should continue to act prudently in protecting themselves and continue to insure their lives and property.

We continue to develop new and improved protection devices. Users of alarm systems owe it to themselves and their loved ones to learn about these developments.

Glossary

Glossary

AC/LB LED: Yellow LED that when lit, indicates the system is running on electricity; when not lit, indicates the system is running on the backup battery.

ALARM: Sound from keypad or other horn/siren indicates a burglar alarm, fire alarm, or other condition you should be alerted to.

ARMED: See ON/OFF.

AWAY: A system setting that protects the premises while it is unoccupied. All burglary sensors are active.

BURGLARY/FIRE: The two major functions of a security system. Fire protection is always on and cannot be turned off. The burglary sensors protect against unauthorized entry into your premises. The burglary protection can be turned on and off and programmed for special levels of access and notification.

BYPASS FEATURE: The Bypass feature allows you to exclude a selected zone or zones from the burglar alarm protection.

BYPASS KEY: Keypad key used to activate the Bypass feature.

CENTRAL STATION: Signal monitoring center contacted by your security system over the telephone and/or other communication channels when alarms are activated if your system is programmed to communicate alarms off site. The central station will follow their procedures and your instructions for contacting the proper authorities when a signal is received.

CHIME FEATURE: An optional feature that causes the keypad to chime for 1 second when selected doors are opened when the burglary protection is off or disarmed. Once programmed by your installer, you can turn Chime on and off by pressing [#], [6].

DURESS: Duress is a system feature that you may have programmed into your system. If someone should force you to turn your system off, you would use the special Duress user code. This code turns the system off and sends a silent duress emergency signal to the central station so personnel can respond appropriately.

Glossary (cont'd)

ENTRY DELAY: The period of time allowed between opening a designated entry/exit door and turning off the alarm system before the system registers an alarm condition. This time is determined at the time of installation. Your system supports two entry times, allowing you to have a different length of time for different doors.

EXIT DELAY: The period of time allowed between turning the system on and leaving through a designated exit/entry door. This is determined at the time of installation.

INTERIOR ZONE: A group of points that protects the interior of your premises. You may want to turn the perimeter portion of your system on while leaving the interior zones off, allowing you to move freely inside, opening interior doors and passing by motion detectors without causing an alarm.

KEYPAD: A keypad is your link to your system. It displays alarm and trouble messages, shows faulted zones, and allows you to turn the system on/off by using the keys. Your system has one or more keypads.

ON/OFF: These terms refer to the burglary portion of your security system. There are several operation levels that allow you to protect part of your premises while you remain inside. Fire and other emergency and environmental sensors are always active and ready, and are not affected in any way by turning the burglary portion of your security system on or off. "Armed", a term that is sometimes used, means "system on". "Disarmed" means "system off." See ON-INSTANT, ON-STAY, and STAY.

ARM LED: Red LED in the upper portion of the keypad. When lit, some part of the burglar alarm system is on; when not lit, the burglary portion of the system is off.

ON-STAY: A system setting that turns on the perimeter protection of the building but allows movement throughout the inside.

PANIC BUTTON: A push button that allows you to signal the central station that you need immediate assistance. Your system has programmable Keypad Send Help Alerts that can also serve as Panic buttons.

Glossary (cont'd)

PERIMETER ZONE: A group of points that protects the exterior of your premises such as your outside doors and windows.

SENSOR: The actual alarm sensor, detector, or device installed to detect an intrusion, fire, or environmental problem. Examples include: door contacts, window contacts, motion sensors, glassbreak sensors, smoke detectors, rate-of-rise heat detectors, temperature sensors, flood/water sensors, and carbon monoxide gas detectors.

SILENT CONDITION: Most types of alarms and troubles alert you with the keypad sounder and the sirens, horns, or speakers located in your premises. The intent is to advise you of the alarm or trouble and allow you to respond promptly. The audible sounds also let intruders know that they have been detected and will hopefully scare them away. In circumstances in which an audible alarm might put your life in danger, those alarms are programmed as silent conditions. For an example, see DURESS.

SYSTEM: Your security system is composed of three main parts: 1) the control panel which functions as the system brain and the link to the monitoring agency (central station); 2) the keypad(s), which inform you of system status and allow you to input commands; 3) security sensors such as door and window contacts, motion sensors, smoke detectors, and other sensors to detect intrusion, fire, and other conditions as needed for your premises.

USER CODE: A 4-digit code that is required to operate the system. The system supports up to 6 separate user codes. The system supports one Master User who can add/delete other user codes. Two of the user codes may be dedicated to special functions as defined by your alarm company at the time of installation. (See System Reference in this guide.)

ZONE: A collection of sensors with common characteristics grouped together for your operating convenience.

Federal Communications Commission (FCC) Statement

This equipment has been tested to FCC requirements and has been found acceptable for use. The FCC requires the following statement for your information:

This equipment generates and uses radio frequency energy and if not installed and used properly, that is, in strict accordance with the manufacturer's instructions, may cause interference to radio and television reception. It has been type-tested and found to comply with the limits for a class B computing device in accordance with the specifications in Subpart J, Part 15 of FCC Rules, which are designed to provide reasonable protection against such interference in a residential installation. However, there is no guarantee that interference will not occur in a particular installation. If this equipment does cause interference to radio or television reception, which can be determined by turning the equipment on, the user is encouraged to try to correct the interference by one or more of the following measures:

- If you are using an indoor antenna, have a quality outdoor antenna installed.
- Re-orient the receiving antenna until interference is reduced or eliminated.
- Move the receiver away from any wire runs to the control/communicator.
- Plug the control/communicator into a different outlet so that it and the receiver are on different branch circuits.

If necessary, the user should consult the dealer or an experienced radio/television technician for additional suggestions.

The user or installer may find the following booklet, prepared by the Federal Communications Commission, helpful: "Interference Handbook."

This booklet is available from the U.S. Government Printing Office, Washington, DC 20402. Stock No. 004-000-00450-7.

The user shall not make any changes or modifications to the equipment unless authorized by the Installation and Setup Guide or User Guide. Unauthorized changes or modifications could void the user's authority to operate the equipment.

Limited Warranty

Fire Burglary Instruments, Inc., a subsidiary of Pittway Corporation, and Pittway Corporation, its divisions, subsidiaries, and affiliates ("Seller"), 149 Eileen Way, Syosset, New York 11791, warrants its security equipment (the "product") to be free from defects in material and workmanship for one year from date of original purchase, under normal use and service. Seller's obligation is limited to repairing or replacing, at its option, free of charge for parts, labor, or transportation, any product proved to be defective in materials or workmanship under normal use and service. Seller shall have no obligation under this warranty or otherwise if the product is altered or improperly repaired or serviced by anyone other than the Seller. In case of defect, contact the security professional who installed and maintains your security equipment or the Seller for product repair.

This one-year Limited Warranty is in lieu of all other expressed warranties, obligations, or liabilities. THERE ARE NO EXPRESS WARRANTIES THAT EXTEND BEYOND THE FACE HEREOF. ANY IMPLIED WARRANTIES, OBLIGATIONS, OR LIABILITIES MADE BY SELLER IN CONNECTION WITH THIS PRODUCT, INCLUDING ANY IMPLIED WARRANTY OF MERCHANTABILITY OR FITNESS, FOR A PARTICULAR PURPOSE OR OTHERWISE, ARE LIMITED IN DURATION TO A PERIOD OF ONE YEAR FROM THE DATE OF ORIGINAL PURCHASE, ANY ACTION FOR BREACH OF ANY WARRANTY, INCLUDING BUT NOT LIMITED TO ANY IMPLIED WARRANTY OF MERCHANTABILITY, MUST BE BROUGHT WITHIN 60 MONTHS FROM DATE OF ORIGINAL PURCHASE. IN NO CASE SHALL SELLER BE LIABLE TO ANYONE FOR ANY CONSEQUENTIAL OR INCIDENTAL DAMAGES FOR BREACH OF THIS OR ANY OTHER WARRANTY, EXPRESS OR IMPLIED, OR UPON ANY OTHER BASIS OF LIABILITY WHATSOEVER, EVEN IF THE LOSS OR DAMAGE IS CAUSED BY THE SELLER'S OWN NEGLIGENCE OR FAULT. Some states do not allow limitation on how long an implied warranty lasts or the exclusion or limitation of incidental or consequential damages, so the above limitation or exclusion may not apply to you.

Seller does not represent that the product may not be compromised or circumvented; that the product will prevent any personal injury or property loss by burglary, robbery, fire, or otherwise; or that the product will in all cases provide adequate warning or protection. Buyer understands that a properly installed and maintained alarm may only reduce the risk of a burglary, robbery, fire, or other events occurring without providing an alarm, but it is not insurance or a guarantee that such will not occur or that there will be no personal injury or property loss as a result. CONSEQUENTLY, SELLER SHALL HAVE NO LIABILITY FOR ANY PERSONAL INJURY, PROPERTY DAMAGE, OR OTHER LOSS BASED ON A CLAIM THE PRODUCT FAILED TO GIVE WARNING. HOWEVER, IF SELLER IS HELD LIABLE, WHETHER DIRECTLY OR INDIRECTLY, FOR ANY LOSS OR DAMAGE ARISING UNDER THIS LIMITED WARRANTY OR OTHERWISE, REGARDLESS OF CAUSE OR ORIGIN, SELLER'S MAXIMUM LIABILITY SHALL NOT IN ANY CASE EXCEED THE PURCHASE PRICE OF THE PRODUCT, WHICH SHALL BE THE COMPLETE AND EXCLUSIVE REMEDY AGAINST SELLER. This warranty gives you specific legal rights, and you may also have other rights that vary from state to state. No increase or alteration, written or verbal, to this warranty is authorized.

Telephone Service Advisory

Telephone Operational Problems

In the event of telephone operational problems, disconnect the control by removing the plug from the RJ31X wall jack. We recommend that your certified installer demonstrate disconnecting the phones on installation of the system. Do not disconnect the phone connection inside the control/communicator. Doing so will result in the loss of your phone lines. If the regular phone works correctly after the control/communicator has been disconnected from the phone lines, the control/communicator has a problem and should be returned for repair. If, upon disconnection of the control/communicator, there is still a problem on the line, notify the telephone company that it has a problem and request prompt repair service. The user may not under any circumstances (in or out of warranty) attempt any service or repairs to the system. It must be returned to the factory or an authorized service agency for all repairs.



149 Eileen Way, Syosset, NY 11791
Subsidiary of Pittway Corporation
Copyright © 1999 PITTWAY CORPORATION



N9942 1/00